

Type	Product Article	Name	Article	Number	Unit
39	3990451	Foam	1998830	1	ST
		Nylon	1008943	0.274	M
		Canvas	1998716	0.134	LM
		Steel Bar	H000013	2	ST
		Tapping Screw	1001534	10	ST
		Washer black	1002994	10	ST
42	3990452	Foam	1998831	1	ST
		Nylon	1008943	0.28	M
		Canvas	1998716	0.14	LM
		Steel Bar	H000013	2	ST
		Tapping Screw	1001534	10	ST
		Washer black	1002994	10	ST
44	3990453	Foam	1998832	1	ST
		Nylon	1008943	0.307	M
		Canvas	1998716	0.147	LM
		Steel Bar	H000013	2	ST
		Tapping Screw	1001534	10	ST
		Washer black	1002994	10	ST
46	3990454	Foam	1998833	1	ST
		Nylon	1008943	0.317	M
		Canvas	1998716	0.154	LM
		Steel Bar	H000013	2	ST
		Tapping Screw	1001534	10	ST
		Washer black	1002994	10	ST
48	3990455	Foam	1998835	1	ST
		Nylon	1008943	0.327	M
		Canvas	1998716	0.16	LM
		Steel Bar	H000013	2	ST
		Tapping Screw	1001534	10	ST
		Washer black	1002994	10	ST
50	3990456	Foam	1998837	1	ST
		Nylon	1008943	0.34	M
		Canvas	1998716	0.167	LM
		Steel Bar	H000013	2	ST
		Tapping Screw	1001534	10	ST
		Washer black	1002994	10	ST

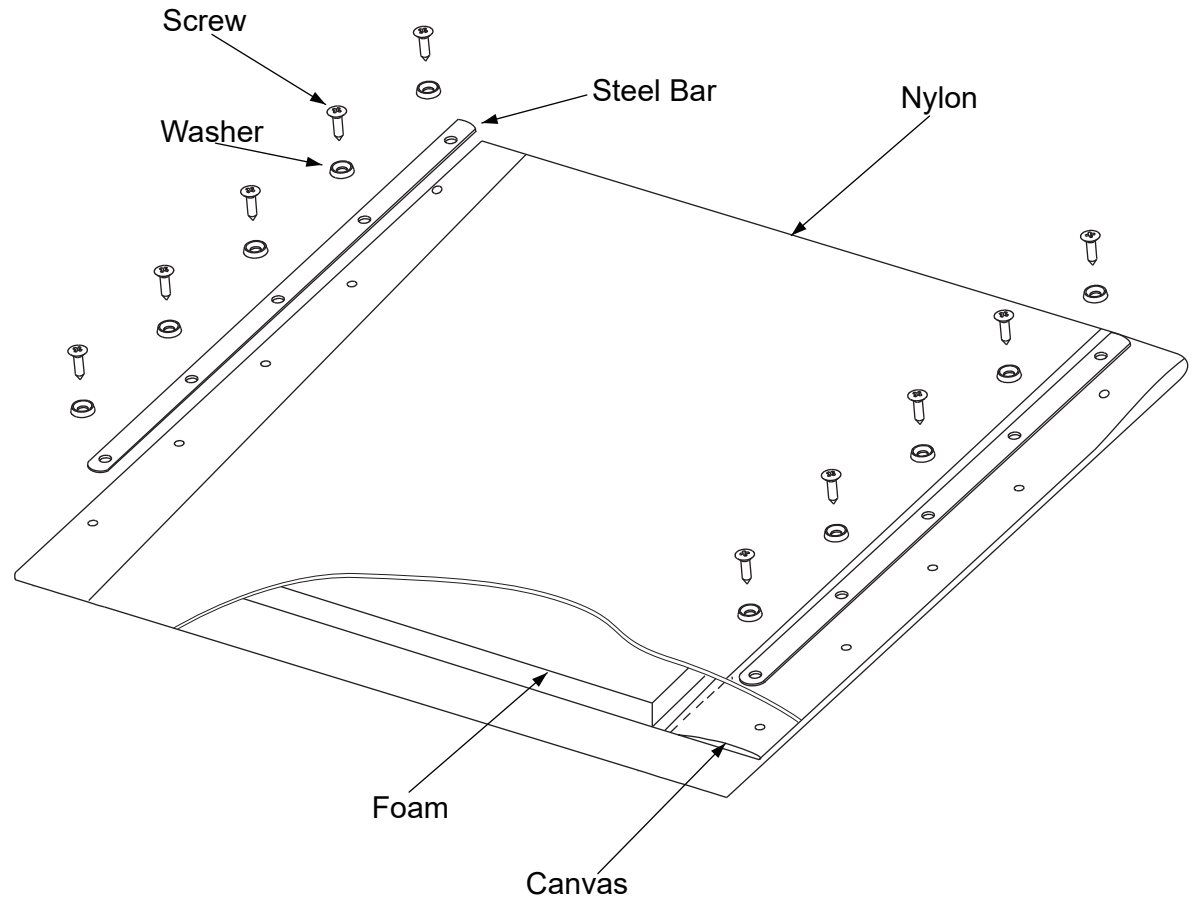

Tolerance	
Value	Tol:
X>0≤50	±0.1
X>50≤100	±0.2
X>100≤150	±0.3
X>150≤500	±0-1
x>500	±1

3992128

EC00311/A

SEAT JAZZ S50

Plan No.

STEP 1/2

EC00311/A

3				
2				
1				
No.	Requested by	Change description	Date	Init.

Scale:1:4	Drafted	Verified	Confirmed
Date	01/02/2016	01/02/2016	01/02/2016
Init.	Mars	JJQ	TG





Cutting the shape of Canvas

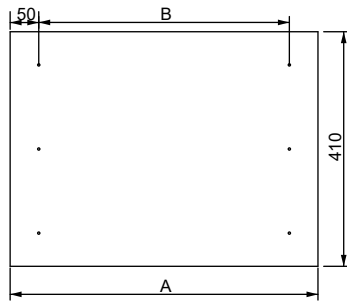

Drilling holes by C525049

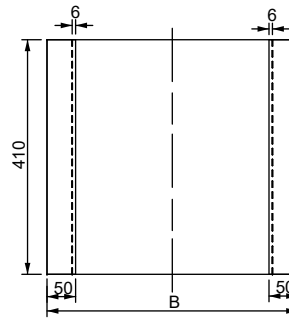

Stitching

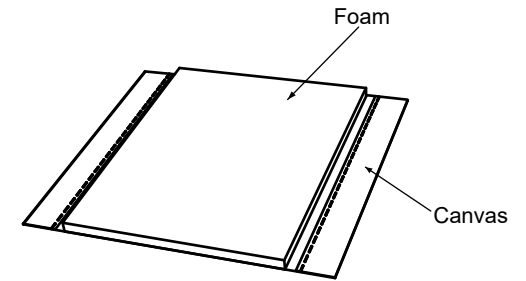

Glue Foam and Canvas use 1999774

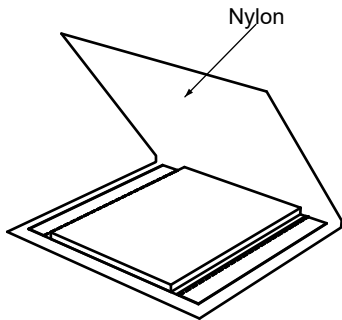

Cover by Nylon

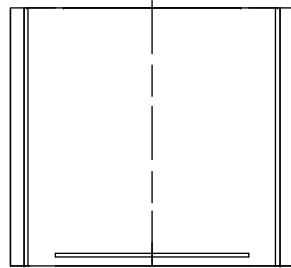

High frequency welding  
By matrix: C400242 39#  
C400243 42#  
C400244 44#  
C400245 46#  
C400246 48#  
C400247 50#

Cut off the excess part along the weld line

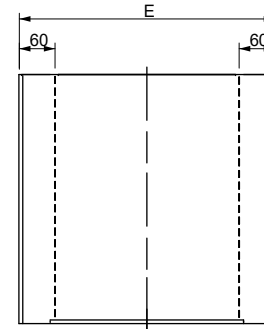
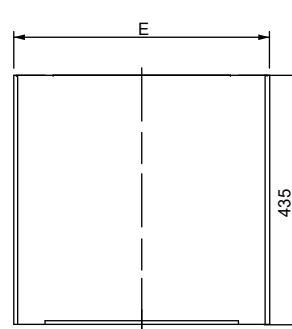

stitching

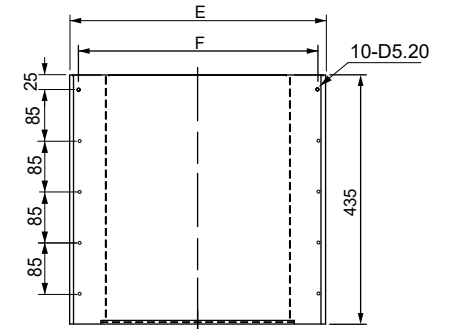

Punching the holes  
By C200874

Type	39#	42#	44#	46#	48#	50#
A	495	525	545	565	585	605
B	395	425	445	465	485	505
C	260	290	310	330	350	370
D	445	475	495	515	535	555
E	400	430	450	470	490	510
F	370	400	420	440	460	480

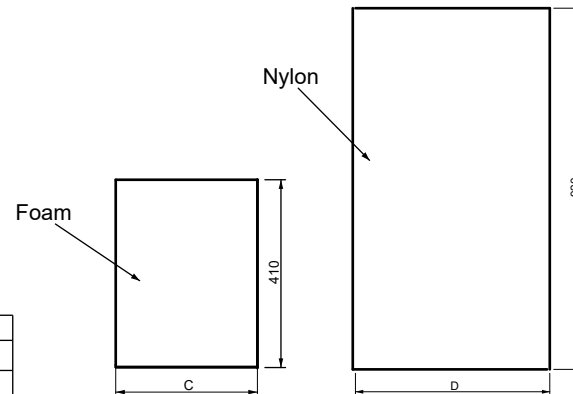

Tolerance	
Value	Tol:
X>0≤50	±0.1
X>50≤100	±0.2
X>100≤150	±0.3
X>150≤500	±0-1
x>500	±1

EC00311/A

SEAT JAZZ S50

Plan No.

STEP 2/2

EC00311/A

3				
2				
1				
No.	Requested by	Change description	Date	Init.

Scale:1:4	Drafted	Verified	Confirmed
Date	01/02/2016	01/02/2016	01/02/2016
Init.	Mars	JJQ	TG



3992128