

Type	Product Article	Name	Article	Number	Unit
39#	3990445	Sponge	1998830	1	ST
		Nylon	1008943	0.274	M
		Canvas	1998716	0.134	LM
		Tapping Screw	1001534	6	ST
		Washer black	1002994	6	ST
		Steel Bar	FC00217	2	ST
42#	3990446	Sponge	1998831	1	ST
		Nylon	1008943	0.28	M
		Canvas	1998716	0.14	LM
		Tapping Screw	1001534	6	ST
		Washer black	1002994	6	ST
		Steel Bar	FC00217	2	ST
44#	3990447	Sponge	1998832	1	ST
		Nylon	1008943	0.307	M
		Canvas	1998716	0.147	LM
		Tapping Screw	1001534	6	ST
		Washer black	1002994	6	ST
		Steel Bar	FC00217	2	ST
46#	3990448	Sponge	1998833	1	ST
		Nylon	1008943	0.317	M
		Canvas	1998716	0.154	LM
		Tapping Screw	1001534	6	ST
		Washer black	1002994	6	ST
		Steel Bar	FC00217	2	ST
48#	3990449	Sponge	1998835	1	ST
		Nylon	1008943	0.327	M
		Canvas	1998716	0.16	LM
		Tapping Screw	1001534	6	ST
		Washer black	1002994	6	ST
		Steel Bar	FC00217	2	ST
50#	3990450	Sponge	1998837	1	ST
		Nylon	1008943	0.34	M
		Canvas	1998716	0.167	LM
		Tapping Screw	1001534	6	ST
		Washer black	1002994	6	ST
		Steel Bar	FC00217	2	ST

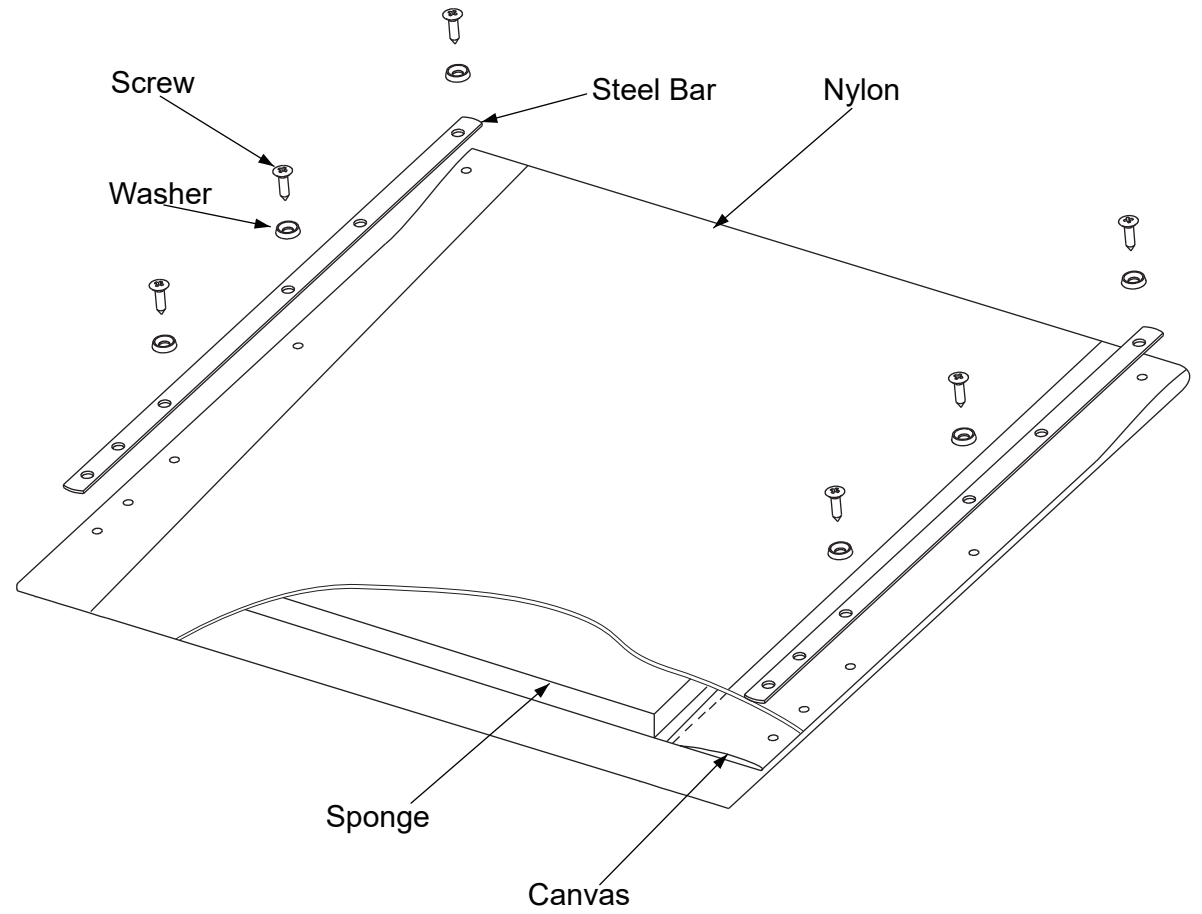

Tolerance	
Value	Tol:
X>0≤50	±0.1
X>50≤100	±0.2
X>100≤150	±0.3
X>150≤500	±0-1
x>500	±1

3991970

EC00312/A

BACK REST JAZZ S50

Plan No.

STEP 1/2

EC00312/A

3				
2				
1				
No.	Requested by	Change description	Date	Init.

Scale:1:4	Drafted	Verified	Confirmed
Date	01/02/2016	01/02/2016	01/02/2016
Init.	Mars	JJQ	TG





Cuting the shape of Canvas

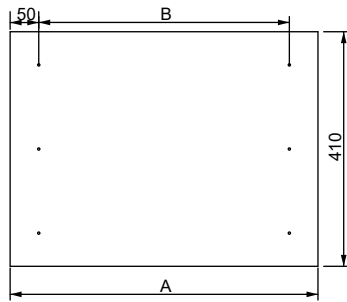

Drilling holes for bend by C525049

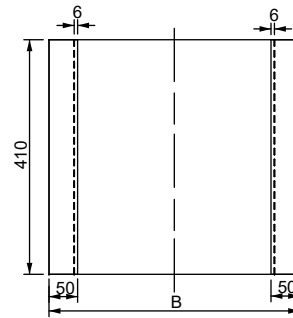

Stiching

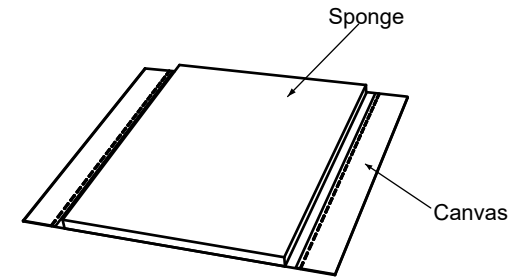

Paste Sponge and Canvas use 1999774

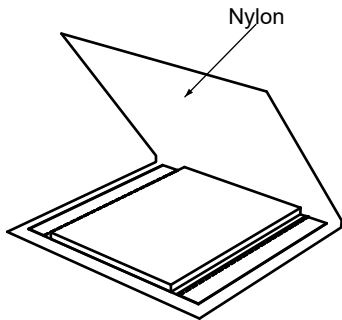

Cover by Nylon

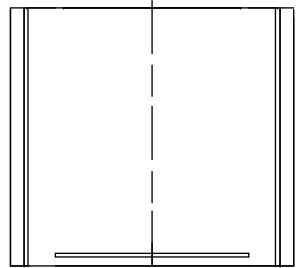

High frequency welding
By matrix: C400235 39#
C400237 42#
C400238 44#
C400239 46#
C400240 48#
C400241 50#

Cut off the excess part along the weld line

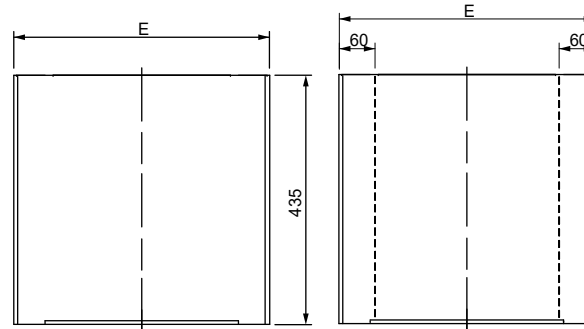

stiching

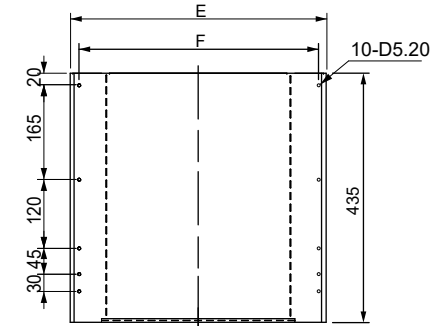

Punching the holes
By C200873

Type	39#	42#	44#	46#	48#	50#
A	495	525	545	565	585	605
B	390	420	440	460	480	500
C	260	290	310	330	350	370
D	445	475	495	515	535	555
E	395	425	445	465	485	505
F	365	395	415	435	455	475

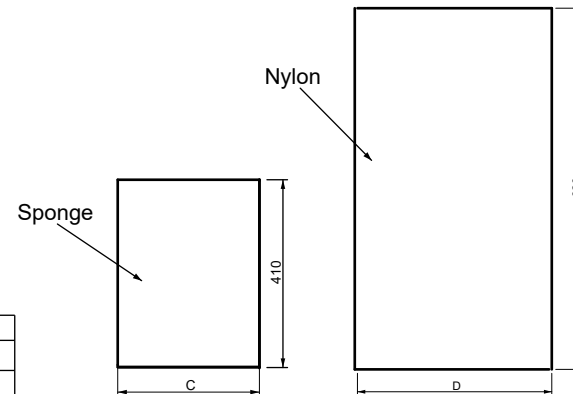

Tolerance	
Value	Tol:
X>0≤50	±0.1
X>50≤100	±0.2
X>100≤150	±0.3
X>150≤500	±0-1
x>500	±1

3991970

EC00312/A

BACK REST JAZZ S50

Plan No.

STEP 2/2

EC00312/A

3				
2				
1				
No.	Requested by	Change description	Date	Init.

Scale:1:4	Drafted	Verified	Confirmed
Date	01/02/2016	01/02/2016	01/02/2016
Init.	Mars	JJQ	TG

